

Detection Zones Diagram of walkthrough metal detector

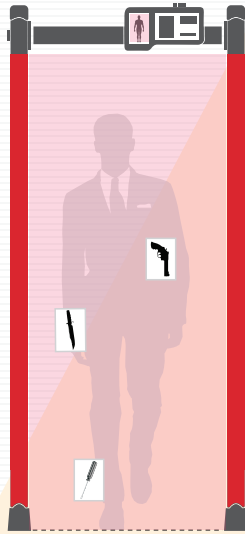

Muti-zone intelligent walk through metal detector

“



Single zone

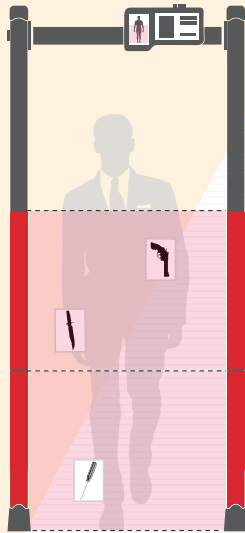

3 zones

Note: mutiple zones will alarm at the same time when detecting metal object.
So it is more precise to detect

”

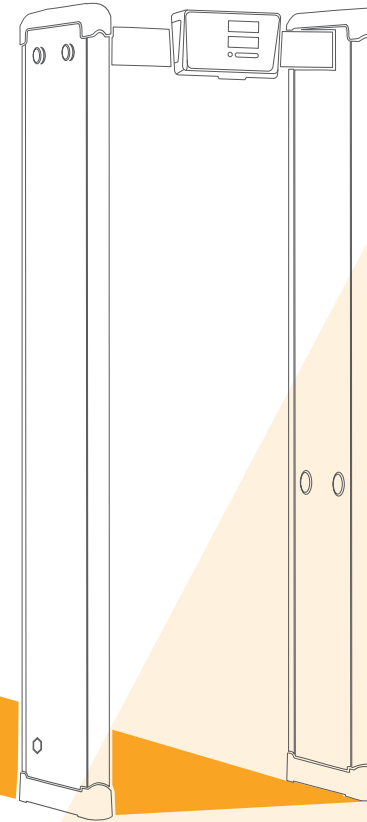

“ INSTALLATION AND OPERATION MANUAL ”

English Version
VIME 20-18-1

SERVICE CARD





Control Panel Settings

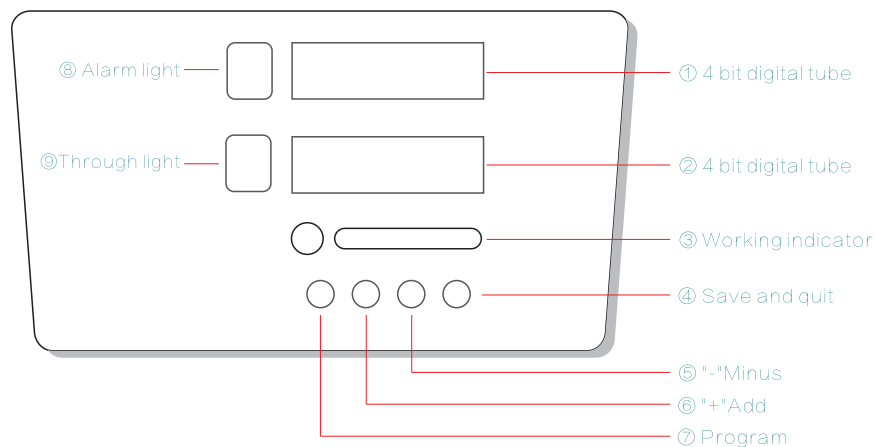

Starting up

Click ④ Power button -starting up, then ① display: P 000.

Input password

Input password, initial password is p 000. ⑧ corresponding selection number (from 0 to 9 cycle) . ⑤ right shift bit digital tube (can cyclic shift , choose corresponding bit twinkling) , if password fault , will reminding: ERR. Press ⑦ (program button) , Reenter password until password is correct. then press ⑦ (program button) access the interface of setting specification.

Revising password

If need to revise password, press ⑦ (program button) Switch to screen display C 000, then keeping pressing ⑦ (program button) about 5s. At present start to twinkle at corresponding position. ⑧ button choose corresponding number (from 0 to 9 cycle) . ⑨ right shift digital button (can cycle shift , choose corresponding twinkling position) inputting new password. Pressing ⑦ (program button) enter into next level setting.

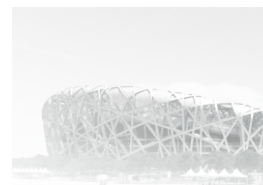

Product Certification is
on Service card back





Warranty Terms

Article 1

In order to protect the legitimate rights and interests of consumers, clear and definite manufacturers, distributors, repair business of walk through metal detector for repairing, replacement, returning (hereinafter referred to as the three package) responsibility, according to <the product quality law of People's Republic of China >, < Consumer Protection Law of People's Republic of China > and the relevant laws and regulations, to constitute this provision.

Article 2

Walk through metal detection door is to point to consumer buy this kinds device for special security check.

Article 3

In the territory of People's Republic of China ,walk through metal gate' s repairing, replacement, returning, shall comply with the provisions of this.

For walk through metal gate ,implement this principle who sell it will be responsible for the three pack.The three package is valid from the seller issued purchase invoice or the installation is calculated from the date of acceptance (the arrival of the goods a week because consumers unilateral factors cannot be installed or invoice, warranty period take effect after one week automatically) .The period of validity of three pack include whole machine,Main component and system quality guarantee period, Quality guarantee period of quick-wear part and other parts.
During three package , if product exists problem of quality, consumers can contact the seller in by three package certification.accordance with the provisions of the replacement, return conditions, consumers with three bags of evidence, repair records, purchase invoices for replacement, return. Beyond the prescribed time limit

Non three packs of responsibility

In the period of validity of the three pack, the seller, the manufacturer, and the repair merchant can prove that one of the following circumstances, does not bear the responsibility of the three package, but shall provide reasonable repair

- 1.Beyond the prescribed time limit
- 2.Transfer to other users
- 3.No valid invoices and three packs of certificates
- 4.The product brand, model, code and requirements on invoice or three package are not in conformity with product required

After-service warranty card

Customer name _____ purchasing date _____
Phone _____ purchasing ways _____
Address _____
Product name _____ Model _____
After-service record _____
After-service record _____
After-service record _____
After-service record _____

REMARKS



RECYCLE © Patented products counterfeiting not allowed



Function Setting

Functional selection



① Alarm counter

program setting



② Pass counter

Functional selection

Press ⑦ keyboard
Can select circularly at following functions

Function	Code
Enter the password	P PXXXX
Working frequency setting	F 0~7
Security level setting	H 0~100
Zones	A 1~3
Sensitivity Settings for each zone	X 0~400
Alarm volume setting	yl 0~10
Alarm tone setting	yd 0~10
Alarm time length setting	d 0~10
Scene setting	AP 1~68
Column lamp switching	LP 0
Battery	BAT 0~99
Automatic frequency	AF 0
Infrared setting	IR 3
The new password	NP NP0000

Spec setting

Under corresponding functional interface, pressing
⑥ keyboard and corresponding no "+"
Pressing ⑥ keyboard and corresponding no "-"

7 levels can be adjusted
100 levels can be adjusted
detector sensitivity 400 level
volume 10 levels
10 levels
Alarm time length 10 levels
68 scenesoption (changing sencurity level,each zone sensitivity mode)
Battery display
3 kinds of infrared mode (0:double infrared both close;1:only front infrared open;2:only back infrared open; 3:double infrared both open)



Before revising device specification,please read this section carefully.



Note: when enter into next interface, spec value of last interface equal to the last operation value



Functional selection

Spec setting

3ZONE

Press ⑦ keyboard
Can select circularly at following
functions

Function	Code	
Enter the password	P	PXXXX
Working frequency setting	F	0~7
Security level setting	H	0~100
Zones	A	3~9
Sensitivity Settings for each zone	L1	0~400
	L2	0~400
	L3	0~400
	R1	0~400
	R2	0~400
	R3	0~400
Alarm volume setting	yl	0~10
Alarm tone setting	yd	0~10
Alarm time length setting	d	0~10
Scene setting	AP	1-68
Column lamp switching	LP	0
Battery	BAT	0~99
Automatic frequency	AF	0
Infrared setting	IR	3
The new password	NP	NP0000

Under corresponding functional interface, pressing
⑥ keyboard and corresponding no "+"
Pressing ⑤ keyboard and corresponding no "-"

7 levels can be adjusted
100 levels can be adjusted

L1 detector sensitivity 400 level
L2 detector sensitivity 400 level
L3 detector sensitivity 400 level
R1 detector sensitivity 400 level
R2 detector sensitivity 400 level
R3 detector sensitivity 400 level

volume 10 levels
10 levels

Alarm time length 10 levels

68 scenes option (changing security level, each zone sensitivity mode)

Battery display

3 kinds of infrared mode (0: double infrared both close; 1: only front infrared open; 2: only back infrared open; 3: double infrared both open)



Product Introduction

Product description

Muti-zone intelligent walkthrough metal detector with high performance, in the meantime, it has higher sensitivity, light weight, best resistance of interference and perfect stability. This model adopts high strength material, more lighter and convenient transportation and installation. With fully modular product, assembly on flow line production, so can keep the stability of production. It is easy to operate with intuitive interface. So can operate without any training.

Muti-zone intelligent walkthrough metal detector is widely used in athletic meeting, conference, school etc. This item is a patented shape and achieves right of software registration. Its detection theory is to use electromagnetic field to detect metal objects, and even detect metal quantity by acousto-optic alarm mode. It consists of the main unit, HF signal generator, infrared sensor. It is most advanced metal detector gate with elegant shape, superior detection ability, multi-zone detection, unique operation network system, portable features.

Technology advantages

- Adaptive system: when system enters into adaptive mode, it can adapt the testing standard
- The sensitivity of each detection zone can be adjusted randomly (with adaptive technology)
- Query function: the system with real-time information query function.
- Detection ability: at least detect 100 persons within one minute.



Installation instructions

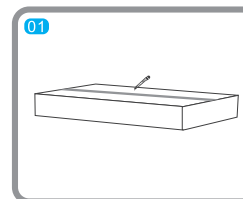

01 Please check whether packing is ok

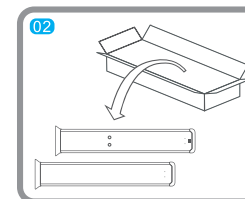

02 Take out left and right door panels from door panel carton

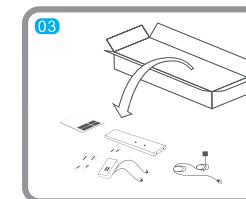

03 Take out the manual, cross beam, host box, power wire from main unit carton

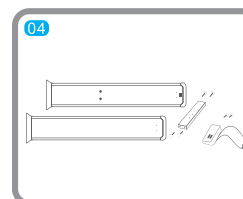

04 Prepare door panel, cross beam, host box, screws according to above diagram

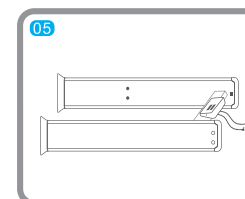

05 Install cross beam and host box according to above diagram, meanwhile tighten screws

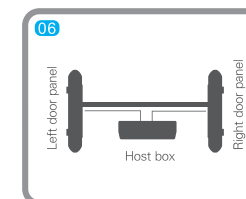

06 Connect the detection wire of host box and both side panels together

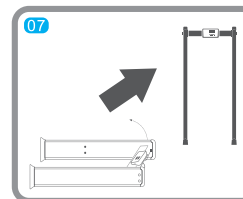

07 Put up the equipment, and finish installation

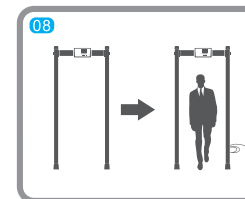

08 Connect power and device, then open starting up button, so device can work normally.



Please first read this section before installing device.

☎ If need our technology supporting when installing and operating or setting specification, please call our service hotline. (refer to cover service card)

If have any doubt and advice regarding our product, please send email to our email address. When we received your email, will reply you immediately. Appreciate your supporting and understanding.



Conductivity electronic interference

Connect the power cord to which is not connected to other large load (such as high-power motors, etc). They may result in a large power line or voltage shocks.

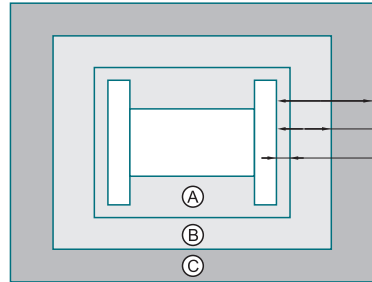

The recommended minimum distance between the interference source.

> 0.5m-4m(20in-157in)

> 0.5m-2m(20in-79in)

> 0.1m(4in)

A: The distance between the fixed metal objects

B: There must be no active metal objects

C: There must be no electrical interference sources

Multiple devices work side by side

Work side by side is to point to multiple devices work close to each other. When work side by side, Walk through metal detector will interfere each other in a certain extent. Interference level is decided the distance between the devices, working frequency, sensitivity.

There is many different working frequencys choosen for walk through metal detector,so can reduce the interference between device in order to work side by side.Please note,when work side by side ,all device should set different working frequency.

Before working, device setting

Operator passes through walk through metal detector with need to be detected metal. In the meantime adjust sensitivity and security level,so that achieve customer's demands(note:factory standarder is that one yuan coin transversely pass and will exist alarm)

Specification

- Detect object:contraband including mobile phone and metal
- weight:netweight24KG,gross weight 26.7KG;
- External size:2140x280x820mm
- Passage size:2030x700x280(the width of passage can be customs made from 700~1500mm)
- Packing size: Door panel:2235X415X170mm ; Main box:395x245x185
- Volume: 0.17m³
- Working humidity:99%,non-condensing
- Working temperature:-40° C~85° C
- Power supply :can equip with backup battery.Can choose sifferent supply time from 8/16/24/48
- hours(optional)
- Input:AC110V-240V50HZ-60HZ
- Output:DC12V/5A 12W

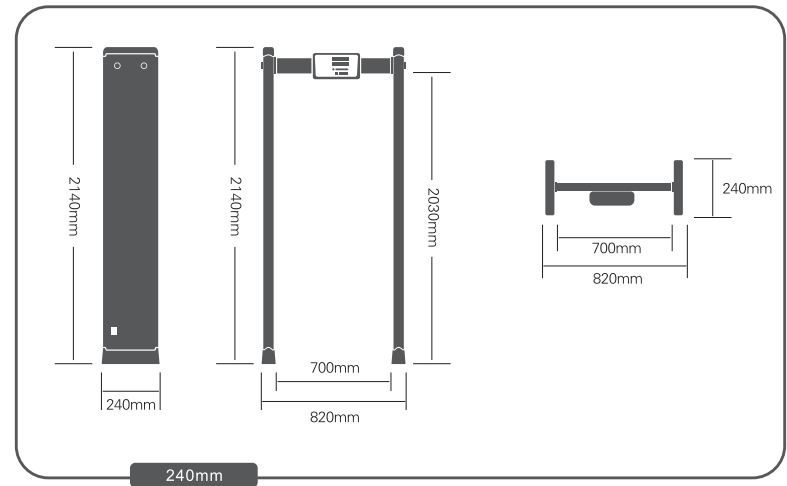

Application occasions

Walkthrough metal detector is used to detect metal object in the body. Typical application occasions as following:

- Airport, port, travelling check point
- Court, visting checking point
- Conference, stadium, access control
- power plant , factory hotel, restaurant, entertainment, power venue, KTV

By research and practice of long terms, we published this style device. And it also is use advanced technology and 100% security. According to the manual operating,will not exist any damage for the person passing through device.





Common Fault Handling

FAQ deal

NO.	Fault name	Fault description	Check failure	Fault judgment	Maintenance Tools
1	Cannot-boot	Can't benormally used after installation and connect the power.	1.Check whether the power line between main chassis and the door panels has been plugged in with AC220V power cord. 2. Check whether the power cord is damaged, broken, poor contact, and the main chassis power supply is normal.	1.Motherboard fault 2.Circuit fault	Visual, Manual operation
2	Boot does not show	The LCD screen does not light Digital board is not bright	Check whether the motherboard connector panel is inserted properly.	Replace connecting line or display and digital board.	Visual, Manual operation
3	No count	The through number shows 0001 or 0000 or even not counting.	We picked up a phone, turn on the camera, the lens on the dot at the door will emit aglowing red dot, which means the infrared emission is normal, if not, the infrared is broken.	Replace the infrared component.	Visual, Manual operation
4	Disorderly alarm	It may appear automatic alarm when there is not staff through the detector.	1. Check the surrou ding environ ment, ortry to change the frequencies. 2. When the sunlight direct to the infrared component, it may also appear automatic alarm.	1. Replace the infrared component. 2.Change the installation location to avoid the sun.	Visual, Manual operation
5	Omission	There is no alarm when walking through the detector with metal.	Normally it is because the sensitivity is too low, try to increase the sensitivity of eachzone.	Debugging capturecard.	Visual, Manual operation



Kind Attention

Installation environment

Shaking Ground

Ground should be flat, with a solid support, to prevent vibration. Especially when there is presence of vibration of the metal structure under the surface, people walk through the detector may cause unnecessary alarms.

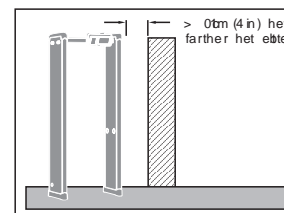

Fixed the metal objects

The distance between fixed or a large metal object should be at least 10cm (4in) away from the WTMD to detect large metals. It has little effect on the sensitivity, but it may make WTMD more susceptible to vibration.



The distance of this section is recommend distance, the actual distance should be decided upon the installation site conditions.

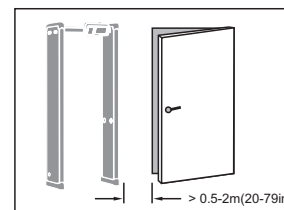

The moving metal objects

The moving metal objects outside the WTMD should keep a distance of 0.5-2m (20-79in) away from the door, thus to avoid false alarms. According to the size of metal objects, the distance between metal objects and the WTMD may be different.

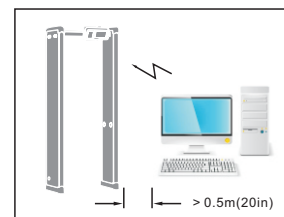

Radiated electrical interference

The distance between electronic interference source and the receiving coil is the largest. The recommended minimum distance should be 0.5-4m (20-157in). However, the actual distance should be depended on the real conditions. For example, you can move the WTMD and the interference source to find the best position.

Interference may be provided by electronic control panel, radios and computers, image display, high-power motors and transformers, AC cord, thyristor control circuits, flash welding equipment fluorescent tubes and other equipment.



Please first read this section before installing device.

